

## RFB Triple Clamps

Please send us the filled out form with your order number to our mail address [info@rf-biketech.de](mailto:info@rf-biketech.de) – if you have any more questions, please contact us via **phone** (+49 971 7851 197).

### IMPORTANT:

Below (and on the next pages) you see three different illustrations for taking measurements: Upper triple clamp, lower triple clamp and steering tube. The measurements to be taken are marked on the illustrations with the letters A, B, C etc. – please enter the measurements below the respective illustration. We then add the missing dimensions (f.e. the heights of the triple clamps etc.) ourselves in our CNC-drawing.

You can either enter the measurements digitally in the PDF file or print them out and send them to us as a scan via e-mail.

**PLEASE NOTE: Specify the diameter measurements exactly, i.e. to the tenth of a millimeter, for example „diameter 25.1 mm“.**

## 1. UPPER TRIPLE CLAMP

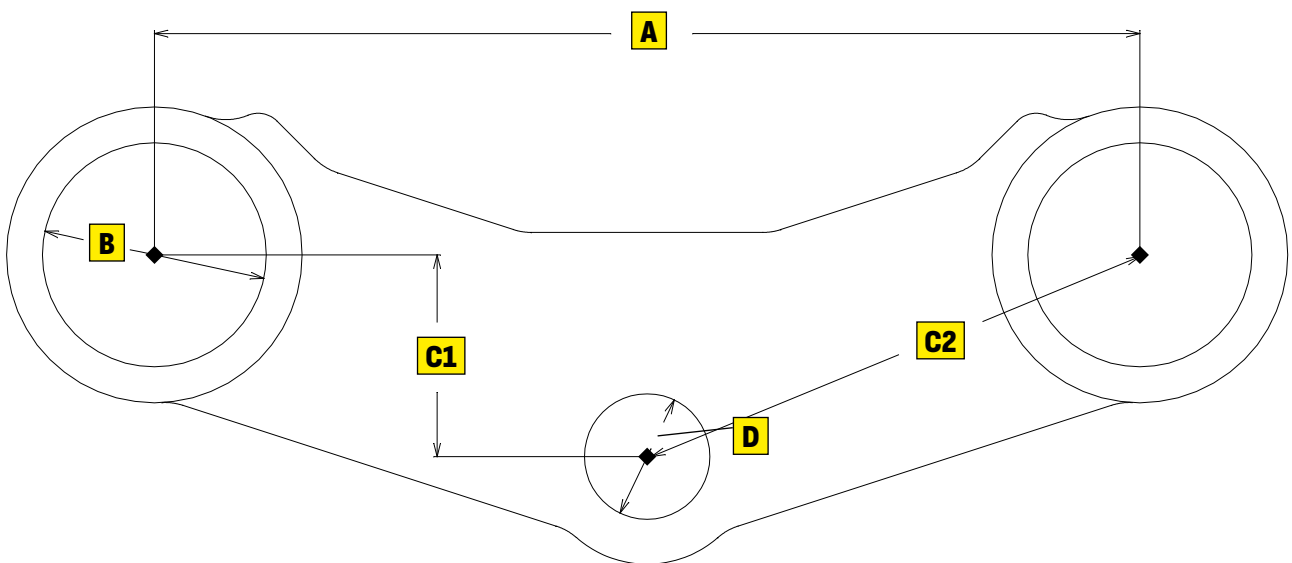

Fork tube distance, center - center

**A**

Diameter fork tube (please specify exactly, f.e. „25,1 mm“)

**B**

Distance steering tube - fork tube, center - center (offset)

**C1**

**C2**

Diameter (please specify exactly, f.e. „25,1 mm“)

**D**

## 2. LOWER TRIPLE CLAMP

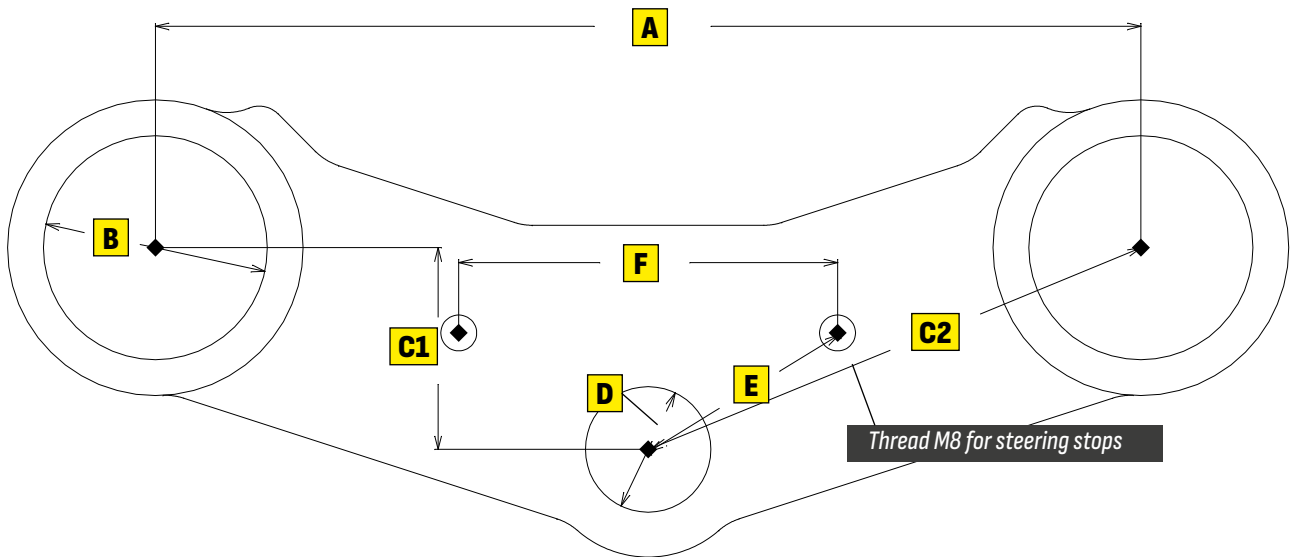

Fork tube distance, center - center

**A**

Diameter fork tube (specify exactly!)

**B**

Distance steering tube - fork tube, center - center (offset)

**C1**

**C2**

Diameter fork tube (specify exactly!)

**D**

Distance to center of steering tube

**E**

Distance center - center steering stops

**F**

## 3. STEERING TUBE

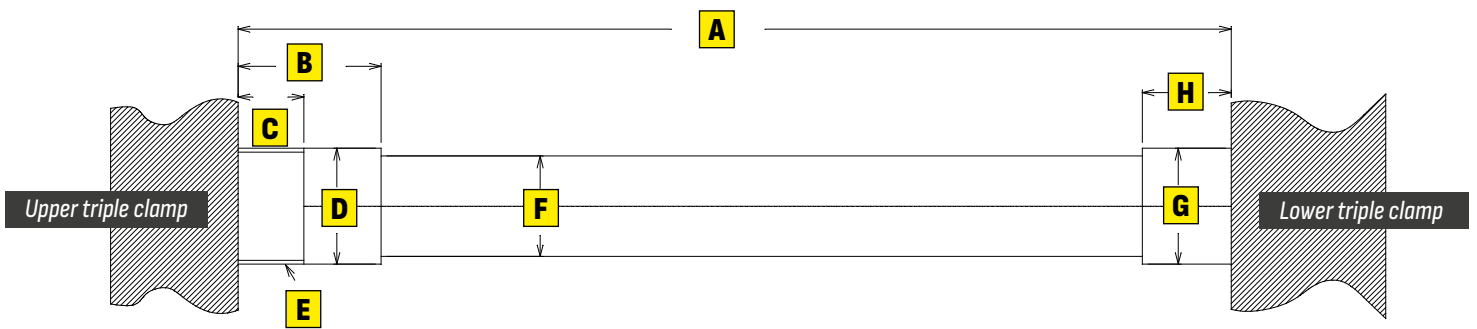

Length fork tube

**A**

Length

**B**

Thread length

**C**

Diameter upper bearing (specify exactly!)

**D**

Thread: M .... x .... (f.e. M 24 x 1)

**E**

Diameter steering tube (specify exactly!)

**F**

Diameter lower bearing (specify exactly!)

**G**

Length

**H**

# COMMENTS

**Here you can enter some comments about your order or the measurements. Please use the gray field below for this.**

Please send us the filled out form with your order number to our mail address **info@rf-biketech.de** – if you have any more questions, please contact us via **phone** (+49 971 7851 197).

**Comments:**